

# Industrial Cold Stores

# Hygiene Solutions

## Hygienic Wall and Ceiling Solutions

### Main Issues in Industrial Cold Stores:

Industrial Cold Stores endure heavy use throughout their lifetimes and often are finished with materials that allow mold and mildew growth. They also have the following issues:

- Rust on walls of chiller
- high levels of fungus and bacteria due to poor finishes leading to failure of food safety requirements and odours
- Peeling of painted surfaces further leading to more corrosion
- Damage to panels due to impact and heavy duty usage
- damage to panels due to heavy cleaning chemicals
- Difficult to renovate panels without dismantling existing room



## Recommended Finishes

### Glasbord® with Surfaseal® for Walls and Ceilings

Hygienic **Glasbord® with Surfaseal®**  
Wall panels by **Crane Composites®**

- Smooth / Embossed Finish
- 1.5mm / 1.9mm / 2.3mm Thick
- Fire Rating: Class C / Class B / Class A / FM Approval
- Available in 1.20m width to any length required, Can be made up to 2.4m Width.
- Color Match is available



Embossed White | 85

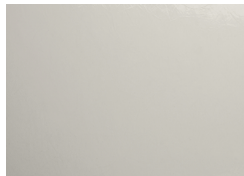

Smooth White | 85



Main Issue	How Glasbord® with Surfaseal® Provides a solution
Rust on walls	Glasbord® with Surfaseal® is lifetime non-corrosive and does not contain any metal.
Mold and Mildew growth leading to Odours and bacteria and loss of food safety	Glasbord® with Surfaseal® does not allow any mold or mildew growth and is ASTM tested.
high levels of damage including paint peel and dents	Glasbord® with Surfaseal® is extremely wearing and resistant to heavy cleaning. It is also completely waterproof and a pore free surface. It is also highly impact and scratch resistant

## Benefits

- ✓ Completely non porous surface, highly washable and stain resistant
- ✓ Chemical Resistant and resistant to repetitive heavy duty cleaning
- ✓ Mold and mildew free
- ✓ High impact and scratch resistance
- ✓ Easy and quick to install
- ✓ HACCP certified
- ✓ Fire rated: Class C , Class A and FM global
- ✓ UL GreenGuard Gold product certified for low chemical emissions
- ✓ Extremely washable and supports repetitive cleaning process.

## Certifications



# Industrial Cold Stores

## Hygienic Wall and Ceiling Solutions

### Installation Options / Engineered Solutions



Glasbord® with Surfaseal® Self Adhesive peel and stick panels (Hygibreak®)



Glasbord® with Surfaseal® laminated on Rigid Board (Hygimat)



Glasbord® with Surfaseal® Sandwich Panels (Hygispan®)

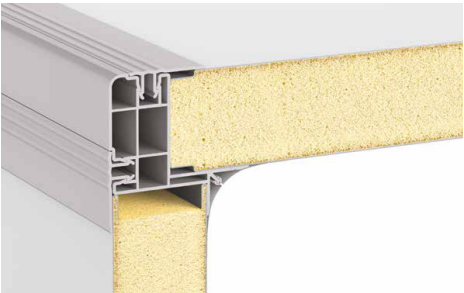

Glasbord® with Surfaseal® Modular Panels (Hygicold)



Traditional Installation

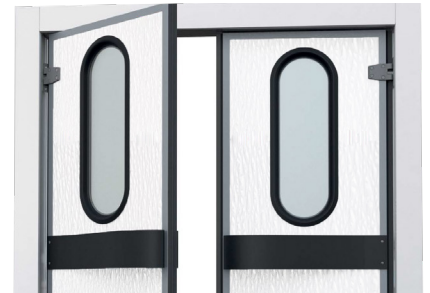

Custom Made Hygienic Doors (Hygidoor)

### Profiles and Accessories

- PVC profiles (division bars, inside corners, outside corners)
- Stainless Steel Profiles
- Safety Barriers
- Polyurathane seam sealant
- Heavy duty skirting
- Suspended Ceiling Grid



PVC Profiles



Polyurathane Seam Sealant

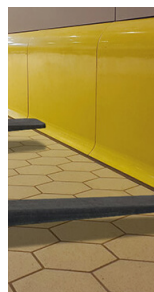

Heavy duty Skirting



Safety Barriers

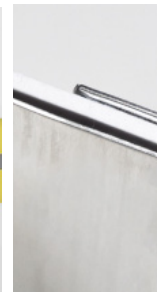

Stainless Steel Profiles

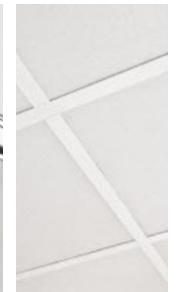

Suspended Ceiling Grid

